

PRACTICE PROFILE

Ap THOMAS PARTNERSHIP



CASE STUDY: COMMUNITY

The Old Smithy, Bangor

Client: Citizens Advice Bureau, Gwynedd

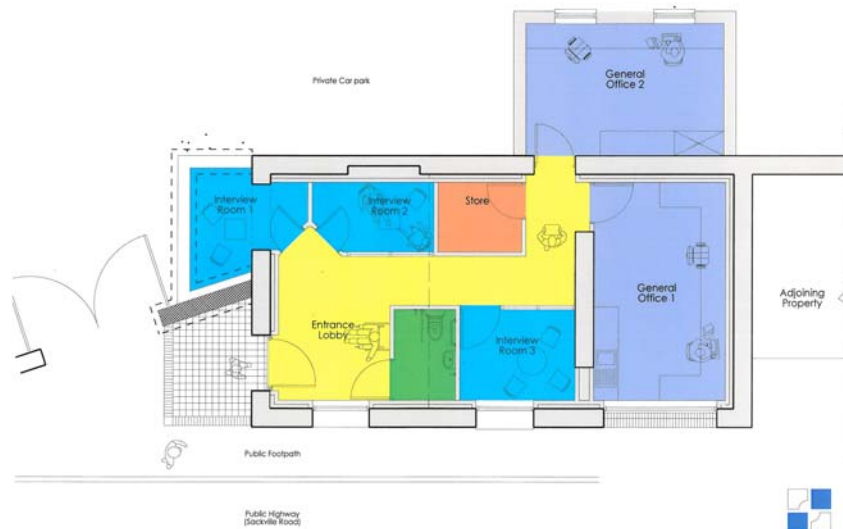

Description:

This is one of Ap Thomas Partnership's projects which commenced with the partnership providing free professional advice to a potential client via the North Wales branch of Business in the Community. Eventually it became a feasible venture which was successful in attracting lottery funding.

Ap Thomas Partnership is now employed by CAB Gwynedd as architects to provide full architectural services to adapt, extend and convert the old smithy to provide CAB facilities in a prominent location near the centre of Bangor.

Works are due to commence in September 2009 and to be completed by end of March 2010.